



City of Del Mar  
 Department of Planning and Community Development  
 1050 Camino del Mar  
 Del Mar, CA 92014

Phone: 858-755-9313 Fax: 858-755-2794  
 Hours: M-TH 1:00 pm – 5:30 pm  
 FRI 1:00 pm – 4:30 pm  
[www.delmar.ca.us](http://www.delmar.ca.us)

**NOI - \_\_\_\_\_ - \_\_\_\_\_**  
 Submittal Date: \_\_\_\_\_ Planner: \_\_\_\_\_  
 Fees: PL: \_\_\_\_\_ ENG: \_\_\_\_\_ GPF: \_\_\_\_\_ Noticing: \_\_\_\_\_  
 Receipt No.: \_\_\_\_\_ Related Projects: \_\_\_\_\_

**Tree Removal Authorized By: \_\_\_\_\_ Application Approved On: \_\_\_\_\_**

## Notice of Intent to Remove a Protected Tree Application

|  |              |
|--|--------------|
| <b>APPLICANT:</b>  |              |
| Applicant(s):  |              |
| <input type="checkbox"/> Owner <input type="checkbox"/> Owner's Agent <input type="checkbox"/> Other _____         |              |
| Mailing Address:   |              |
| City / State:  | Zip:         |
| Phone No(s):   |              |
| Email:   |              |
| Signature(s):  |              |
| <b>OWNER (if not primary applicant listed above):</b>  |              |
| Owner:   |              |
| Mailing Address:   |              |
| City / State:  | Zip:         |
| Phone No(s):   |              |
| Email:   |              |
| Signature(s)<br><small>(authorizing applicant to submit application):</small>                                      |              |
| <b>PROJECT DETAILS:</b>  |              |
| Project Address / Location:  |              |
| Assessor's Parcel No(s).   |              |
| Zoning:  | Overlay Zone |
| Does project involve work within the public right-of-way: <input type="checkbox"/> yes <input type="checkbox"/> no |              |

**Tree(s) to be Removed:**

Submit a site plan (see attached sample site plan) showing all structures and protected trees on site. Also show off-site primary structures or protected trees that are located within 12 feet of the tree(s) proposed for removal. Clearly indicate which tree(s) is proposed for removal.

|   |  |         |  |
|---|--|---------|--|
| Species:  |  | Number: |  |
| Trunk Circumference:<br><small>(measured 2 ft above ground)</small> |  | Height: |  |

***Mark the appropriate statement that describes how your proposed tree removal is exempt from receiving a Tree Removal Permit:***

|  |  |
|--|--|
|  | The subject tree(s) is located within 12 feet of the exterior wall of a primary structure.   |
|  | The subject tree(s) is located within 12 feet of another protected tree.   |
|  | The proposed removal of subject tree(s) qualifies as an emergency tree removal in accordance with Section 23.50.040-B-4 of the Del Mar Municipal Code. |

# SITE PLAN

5462 ZAPO STREET

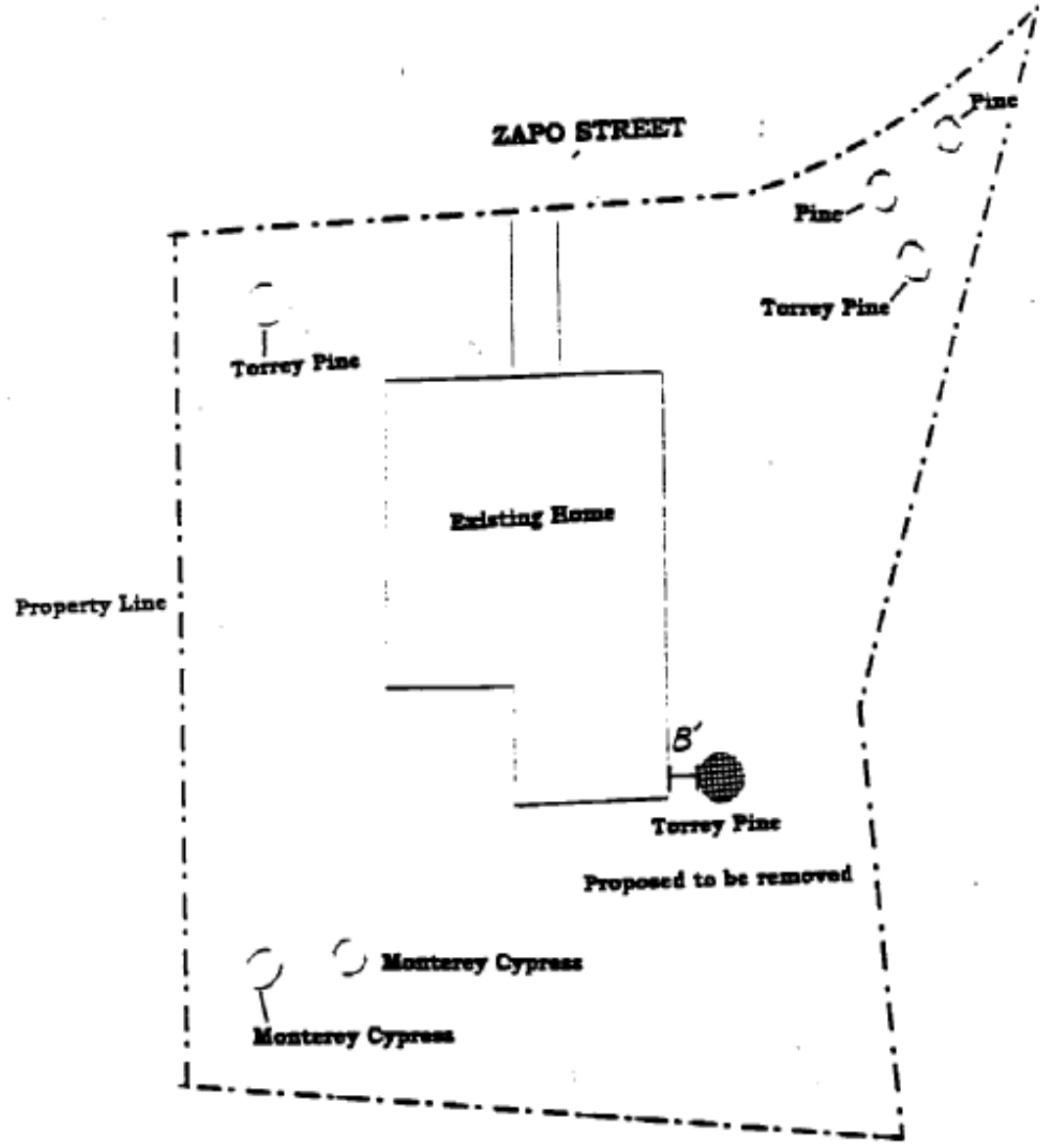



IS YOUR CONSTRUCTION PROJECT CONSIDERED A "PRIORITY"?

|   |                                     |                                    |
|---|-------------------------------------|------------------------------------|
| <b>1. Construction site of 50 acres or more in size where grading will occur during the wet season (October 1-April 30)?</b>          | <b>Yes</b> <input type="checkbox"/> | <b>No</b> <input type="checkbox"/> |
| <b>2. Construction site of 1 acre or more and tributary to or within 200 feet of the City's Water Quality Sensitive Areas (WQSA)?</b> | <b>Yes</b> <input type="checkbox"/> | <b>No</b> <input type="checkbox"/> |
| <b>3. Is the construction site required to obtain coverage under the State General Construction Permit?</b>                           | <b>Yes</b> <input type="checkbox"/> | <b>No</b> <input type="checkbox"/> |

If any of the previous answers resulted in a "Yes", your project is considered a "Priority Construction Project" and is subject to increased inspections by City staff along with increased construction-phase Best Management Practice (BMP) requirements.

If all of the previous answers resulted in "No", your project is considered a "Non-Priority Construction Project" and is subject only to the minimum construction-phase BMP requirements.

|  |  |
|--|--|
|  | <p><b>Construction Project Designation:</b>    <b>Priority</b> <input type="checkbox"/>                      <b>or</b>                      <b>Non-Priority</b> <input type="checkbox"/></p> <p>(Check the box that applies)</p> |
|--|--|

By signing this form, I acknowledge that I have read and understand the statements above, and take complete responsibility for any pollutants that may be generated and discharged to the City Storm Drain System from the development site described on this form.

\_\_\_\_\_  
Signature of Property Owner

\_\_\_\_\_  
Date

\*\*\*\*\*

For Department Use Only

|   |
|---|
| <p>This form has been reviewed by: _____</p> <p>Staff determination as a "Priority Development Project": _____</p> <p>Staff determination as a "Priority Construction Project": _____</p> |
|---|

|   |  |  |                                     |   |  |   |  |  |
|---|--|--|-------------------------------------|---|--|---|--|--|
| <p><b>Potential Areas of Concern/Issues</b></p> <table style="width: 100%;"> <tr> <td><input type="checkbox"/> Soil erosion potential</td> <td><input type="checkbox"/> Proximity of receiving water bodies</td> </tr> <tr> <td><input type="checkbox"/> Site slope</td> <td><input type="checkbox"/> Non-storm water discharges</td> </tr> <tr> <td><input type="checkbox"/> Project size and type</td> <td><input type="checkbox"/> Past record of non-compliance by the operators of the site</td> </tr> <tr> <td><input type="checkbox"/> Sensitivity of receiving water bodies</td> <td><input type="checkbox"/> Any other relevant factors (Please note in the section below)</td> </tr> </table> | <input type="checkbox"/> Soil erosion potential  | <input type="checkbox"/> Proximity of receiving water bodies | <input type="checkbox"/> Site slope | <input type="checkbox"/> Non-storm water discharges | <input type="checkbox"/> Project size and type | <input type="checkbox"/> Past record of non-compliance by the operators of the site | <input type="checkbox"/> Sensitivity of receiving water bodies | <input type="checkbox"/> Any other relevant factors (Please note in the section below) |
| <input type="checkbox"/> Soil erosion potential   | <input type="checkbox"/> Proximity of receiving water bodies                           |  |                                     |   |  |   |  |  |
| <input type="checkbox"/> Site slope   | <input type="checkbox"/> Non-storm water discharges                                    |  |                                     |   |  |   |  |  |
| <input type="checkbox"/> Project size and type  | <input type="checkbox"/> Past record of non-compliance by the operators of the site    |  |                                     |   |  |   |  |  |
| <input type="checkbox"/> Sensitivity of receiving water bodies  | <input type="checkbox"/> Any other relevant factors (Please note in the section below) |  |                                     |   |  |   |  |  |

|  |
|--|
| <p>Staff Notes: _____</p> <p>_____</p> <p>_____</p> <p>_____</p> |
|--|

Referral to City of Del Mar Clean Water Manager is needed: Yes  No